

# NORFAB Wolverine

## Material List

Norfab has taken great care to ensure all parts are of quality material and complete. Please check the unit over carefully. Should you experience any problems or have any questions, **DO NOT CALL THE STORE**, contact NorFab immediately at 1-800-465-2918.

1 - 48" Wall panel with door

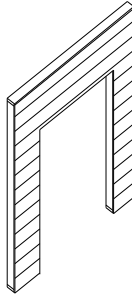

4 - 72" - 2x4 Front & Rear top plates

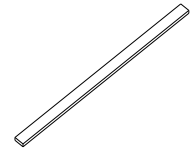

4 - 48" Sidewall panels  
1 - 48" Middle back panel

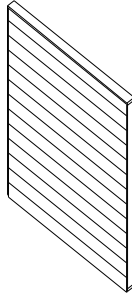

2 - 89" - 2x4 Side top plates

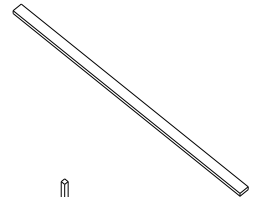

6 - 2x2 Wall joint boards



1 - 44-1/2" Front Left wall panel with window opening

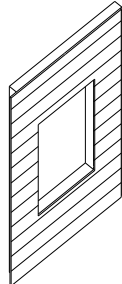

8 - 2x2 Corner trim boards with 45° bevel



2 - 2x6 x 96" Cantilever support



1 - 44-1/2" Front right wall panel  
1 - 44 \_" Back Left wall panel  
1 - 44 \_" Back Right Panel

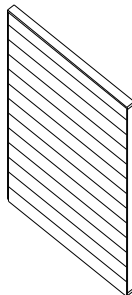

2 - 2x6 x 48" Cantilever support



2 - 2x6 x 65" Cantilever Braces

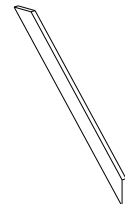

**Customer Service Hotline 1-800-465-2918**  
**NORFAB 12'x8' Wolverine**

**10 - 2x6 x 83 1/4"  
Rafters**

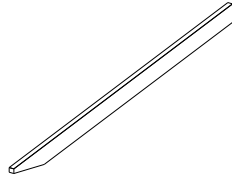

**4 - Mono trusses  
with siding**

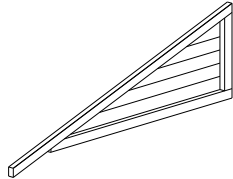

**8 - Triangle  
gussets**

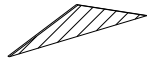

**4 - Rectangle  
gussets**



**1 - Special gusset**

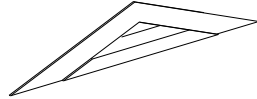

**2 - 1x6 x 96" Side  
fascia**

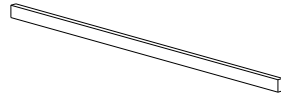

**2 - 1x6 x 48" Side  
fascia**



**2 - 48" x 96"  
OSB roof sheathing**

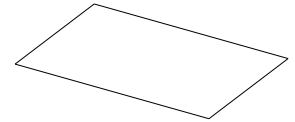

**2 - 35 1/4" x 96"  
OSB roof sheathing**

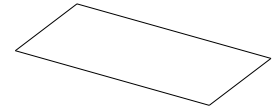

**2 - 48" x 83 1/4"  
OSB roof sheathing**

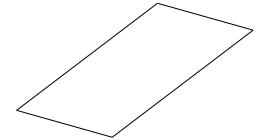

**2 - 96" x 7" Soffits**



**2 - 48" x 7" Soffits**



**4 - 1 x 6 84 \_" Front  
and Rear fascia**



**Customer Service Hotline 1-800-465-2918**  
*NORFAB 12' x 8' Wolverine*

**Door Hinges**

**Screen Door Handle**

**1 - Pre Hung Door**

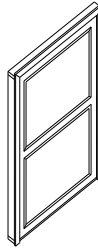

**1 - Pine Screen Door**

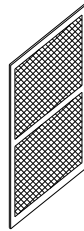

**3 - 48" x 96" - 2x6 Floor Frames**

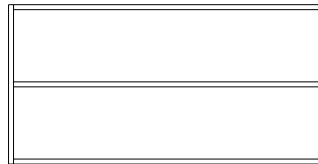

**12 - 21" - 2x6 Blocks**

**3 - 48" x 96" - 5/8" plywood Sheets**

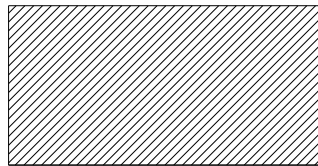

**Nails**

**Screws**

**Customer Service Hotline 1-800-465-2918**

*NORFAB 12' x 8' Wolverine*

# NORFAB Wolverine

## Instructions

Norfab has taken great care to ensure all parts are of quality material and complete. Please check the unit over carefully. Should you experience any problems or have any questions, **DO NOT CALL THE STORE**, contact NorFab immediately at **1-800-465-2918**.

Thank you for purchasing the Wolverine mini cabin. The Wolverine has been designed for easy assembly and is pre-fabricated as much as possible. Please read the instructions over carefully before you begin assembly.

### FLOOR

Make sure you have a level and solid base to place the floor onto. Our suggestion is to use 4 - 8' treated 4x4 posts and place them under the edges and each seam in the floor. These would be placed on 12 patio blocks (none of this is supplied). You should always check with the local building authorities for proper code requirements.

The floor frame is assembled from 3 - 48" x 96" frames. Attach the 96" sides together with the 3" nails provided. Now place the 4' x 8' plywood on top of the frames and nail to the frame with the 1-1/2" nails provided.

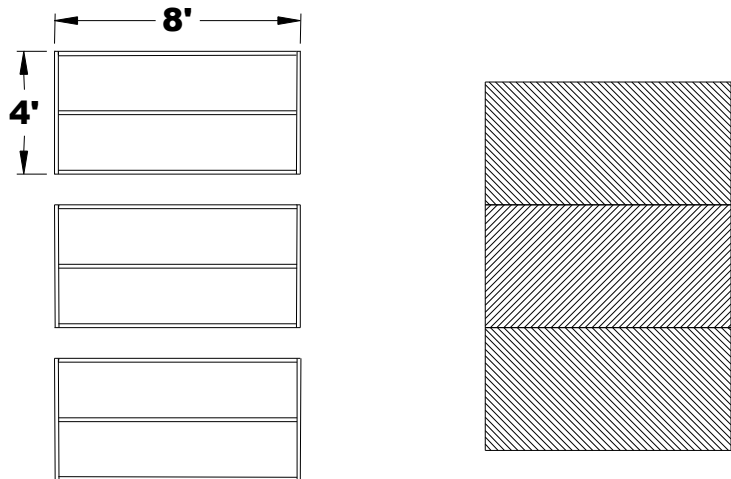
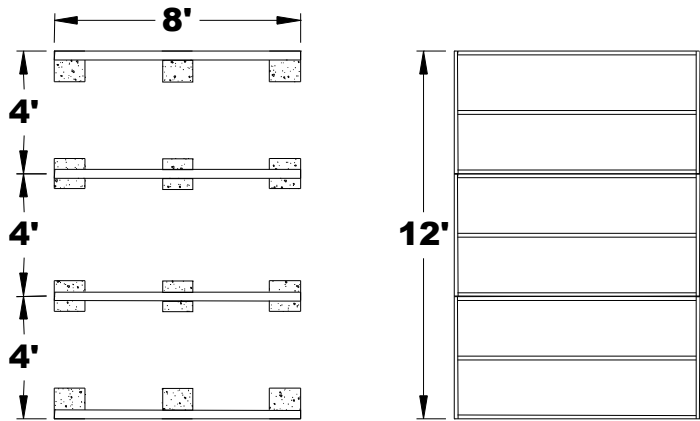

**Customer Service Hotline 1-800-465-2918**

NORFAB 12' x 8' Wolverine

## **WALLS**

Beginning with left front or window wall, stand the walls up keeping the outside front flush with the edge of the floor (Do not nail any walls to the floor until all are standing. This will allow for any necessary adjustments later). While having someone hold this wall get the left side wall (48") and stand on the floor flush with the side of the floor and against the front wall. The framing will meet together for nailing. Attach these 2 wall to each other using the 3" nails provided.

Now place the next 48" side wall to the first, then begin the back wall. Install the wall joint boards as you go to ensure a snug fit. The first back wall (44 1/2") is now attached to the side wall in the same fashion as the front was. Continue installing walls around the building until completed at the front door section. Follow the diagram for wall sizes and order. Once all of the walls are up and fitting the floor edges, nail them to the floor with the 3" nail. Install the top plates as shown in the diagram covering the wall joints.

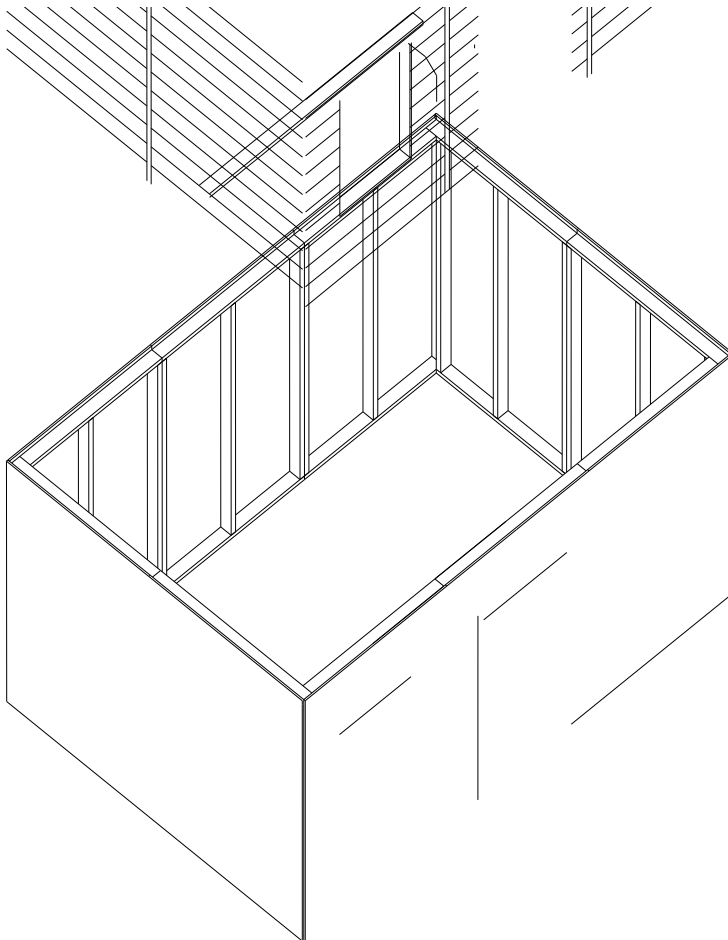
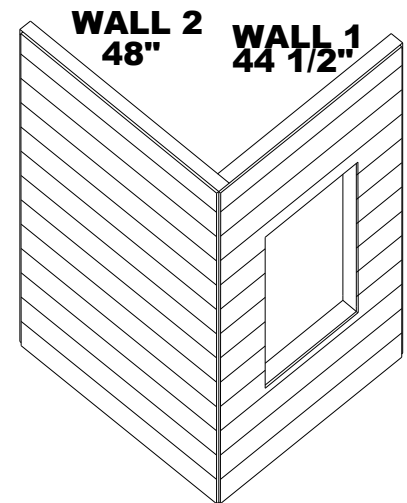
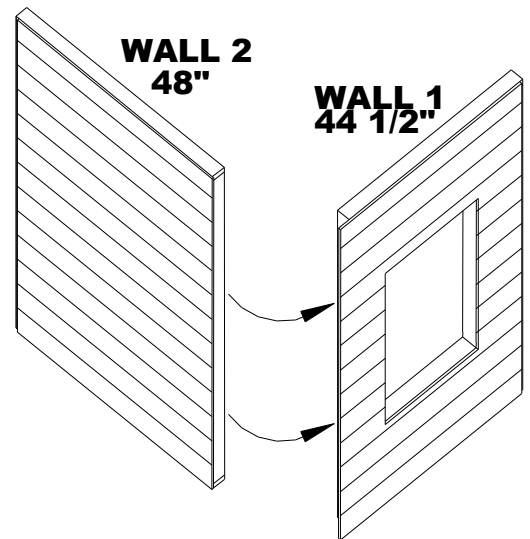

**Customer Service Hotline 1-800-465-2918**

**NORFAB 12' x 8' Wolverine**

## **DOOR**

The steel door provided is pre-hung in a frame. Stand the door into the opening and shim as necessary until square and level. Nail using the 3" nails provided. Attach the screen door using the butt hinges provided. Make sure the door is level and square. The hinges should be approximately 12" from the top and bottom. Install hardware (not supplied)

## **CANTILEVER SUPPORTS**

The cantilever support is made up of 1 - 2x6 x 96" and 1 - 2x6 x 48" as well as 1 angle cut 2x6 for each side. Starting at the rear of the building, place the 48" support flush with the top and back edge of the wall. Nail to wall plates and studs every 6" with the 3" nails provided. Now attach the 96" piece tight to the 48", and nail using the 3" nails provided. Notice that 48" will be out front of the building.

Attach the cantilever braces with the 3" nails as shown.

## **ROOF FRAMING**

Place the rear truss on a flat surface with the log siding facing down. Join the flat edges together as shown and nail a gusset to it with the 1-1/2" nails, repeat for the front wall truss. These will now be a template for the center and cantilever rafters. Place the rafter material onto the top cord of the truss and nail a gusset to each side (when nailing gussets be sure and use lots of nails). When these are complete you should have 4 sets of rafters, 1 special front rafter with a special gusset on one side only, and 2 complete front and rear wall rafters

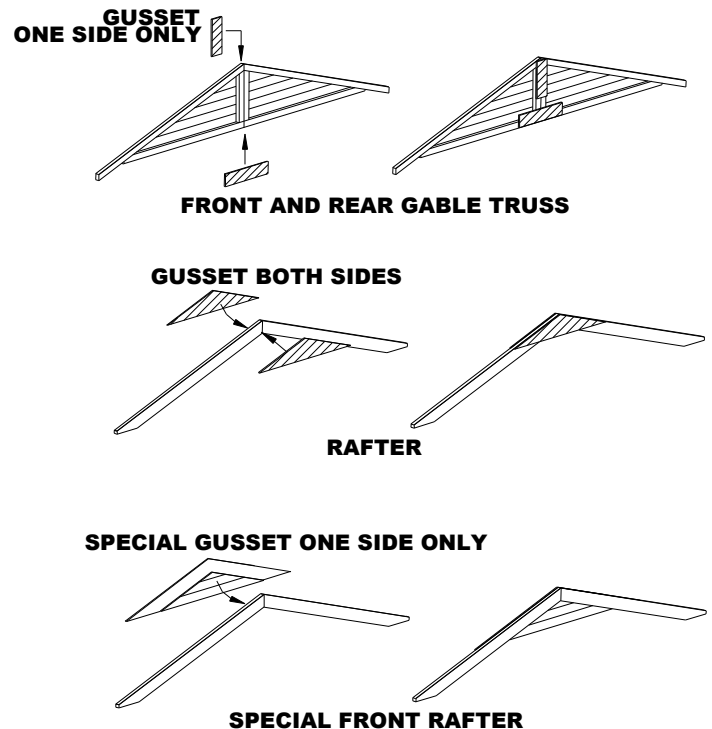

**Customer Service Hotline 1-800-465-2918**

*NORFAB 12' x 8' Wolverine*

Starting at the front, stand the special front rafter up at the edge of the cantilever support and nail. Now move along with a regular rafter 24" on center. The next is the front wall truss, then 3 regular rafters, and finally the rear wall truss. All the rafters and trusses must extend 7" past the outside edge on each side of the cantilever support, and must be 24" on center apart from one another. Although not necessary, it is a good idea to install scrap material along the inside of the rafters at the top to hold them at 24" apart on center.

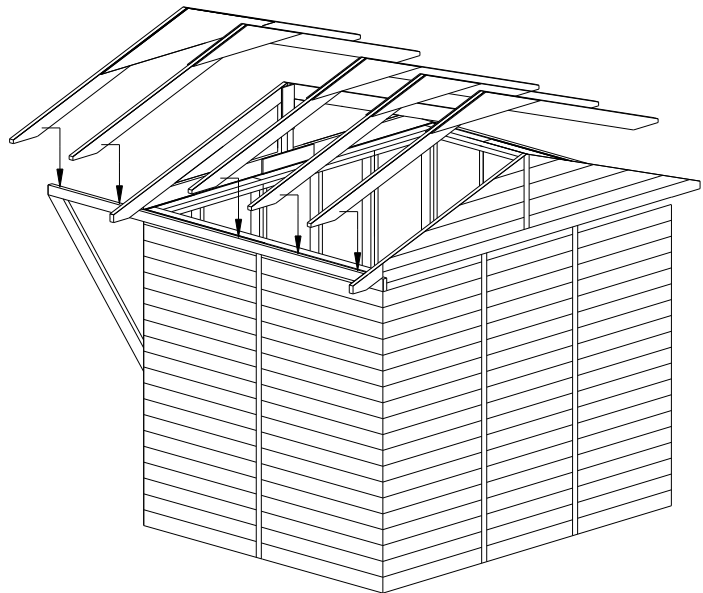

### **SIDE FASCIA**

Attach the side fascia to the ends of the rafters with 1 - 1/2" nails. Then attach the front and rear fascia

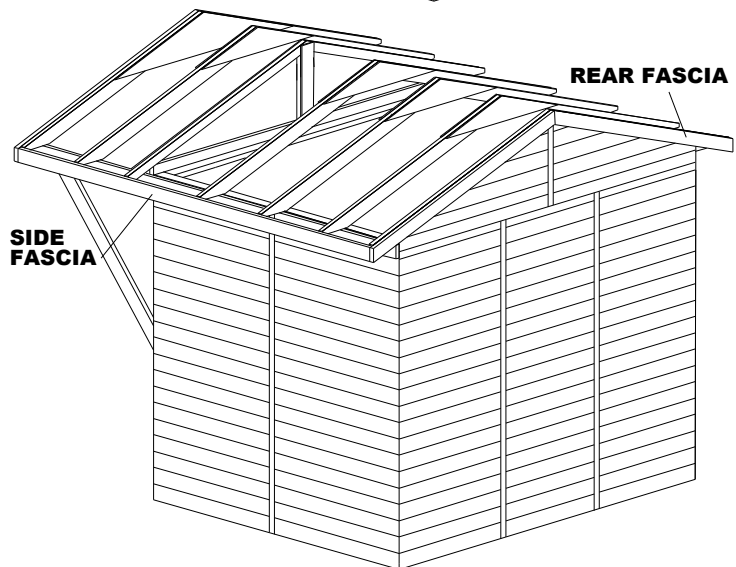

### **ROOF SHEETING**

Starting at the inside edges of the fascia, install the roof sheeting as shown in the diagram using 1-1/2" nails.

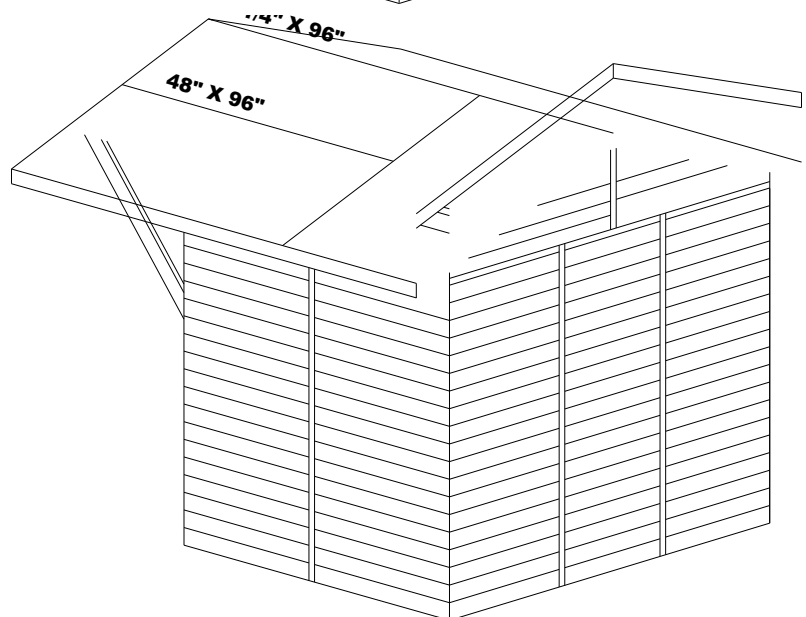

**Customer Service Hotline 1-800-465-2918**

**NORFAB 12' x 8' Wolverine**

**SOFFIT**

Install soffit under the eaves with 1-1/2" nails flush with the front and rear walls.

**CORNER TRIM**

Install the beveled corner trim by placing two pre-cut 45 degree pieces together at each corner.

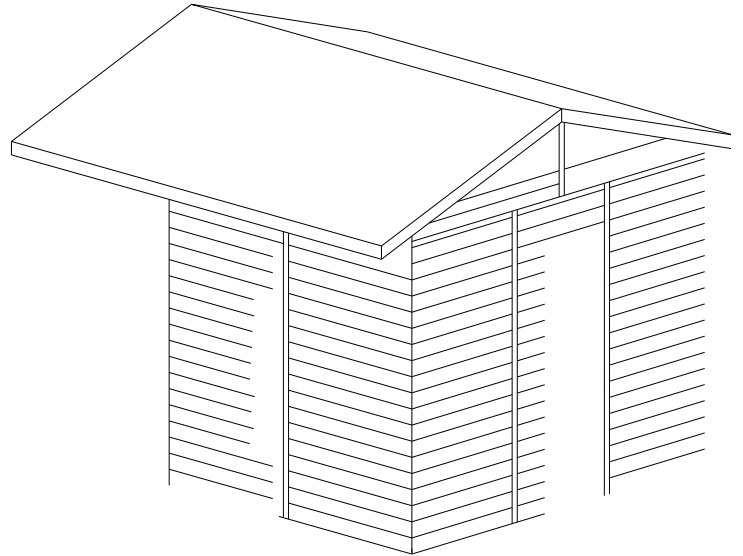

**WINDOW**

Although the window is not supplied a 24" x 42" window opening is prepared for you.

**SHINGLE**

As per shingle manufacturers specifications

**Enjoy your new NORFAB Wolverine Mini-Cabin!**

**Customer Service Hotline 1-800-465-2918**

*NORFAB 12' x 8' Wolverine*